

**ACCESS** Located close to the major transport hubs and airports, Nara is easily accessible from Japan's major cities and overseas.

Nara Prefectural Convention Center is about a 10-minute walk from the nearest station (Kintetsu Shin-Omiya Station). By the direct airport limousine bus, it takes about 100 minutes from Kansai International Airport making it easy to access from overseas.

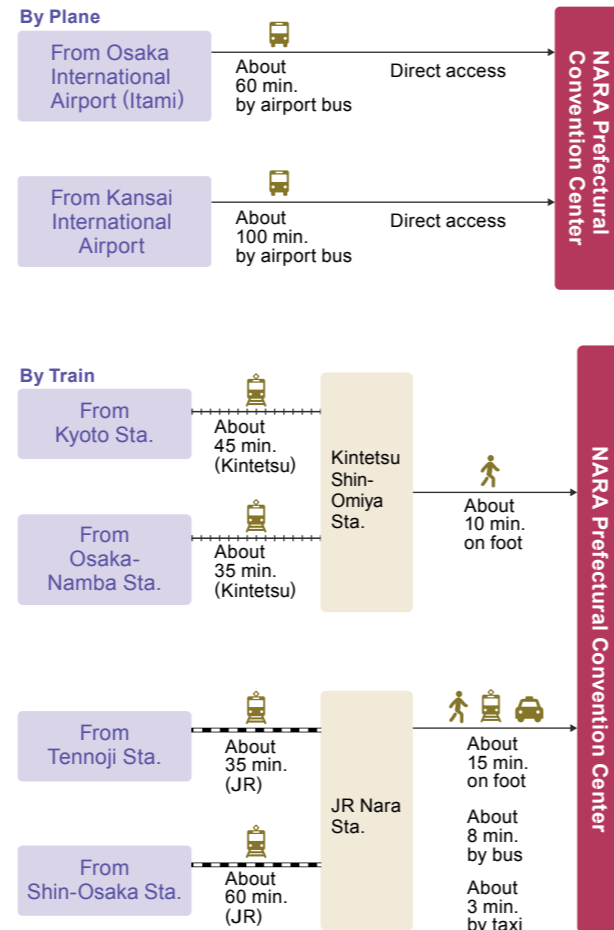
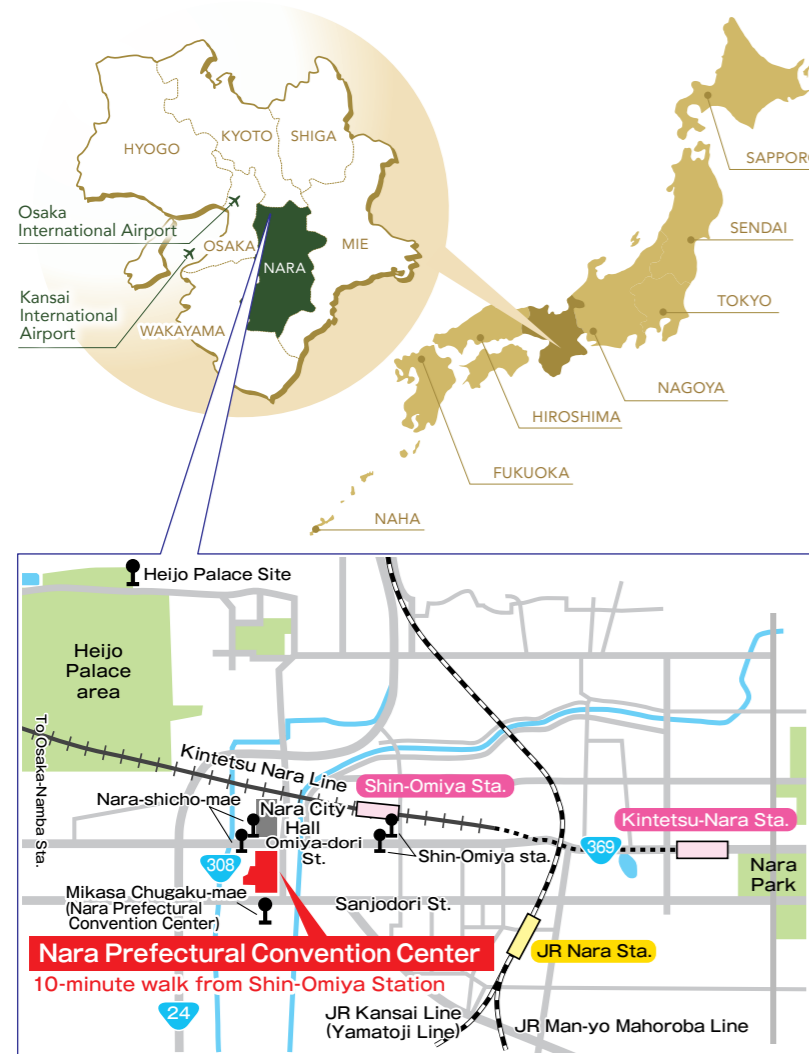

**Parking / Bicycle Parking**

**Parking** Space 400cars \*The first hour free \*The maximum fee:1,000 yen for every 24 hours **Bicycle Parking** Free

**Underground Parking**

Opening hours: 0:00-24:00 (24 hours a day)  
Charges: 100 yen/30 minutes (8:00-24:00)  
100 yen/60 minutes (0:00-8:00)

**Ground Parking**

Opening hours: Entry between 8:30-21:00  
Exit between 8:30-22:00  
Charges: 100 yen/30 minutes (8:00-24:00)  
100 yen/60 minutes (0:00-8:00)

Space 128 bicycles 24 motorbikes

**Places to visit near Nara Prefectural Convention Center**

The Center is located in the middle of Nara city between Nara Park and Heijo Palace Site, full of UNESCO World Heritage sites and well-preserved temples and shrines.

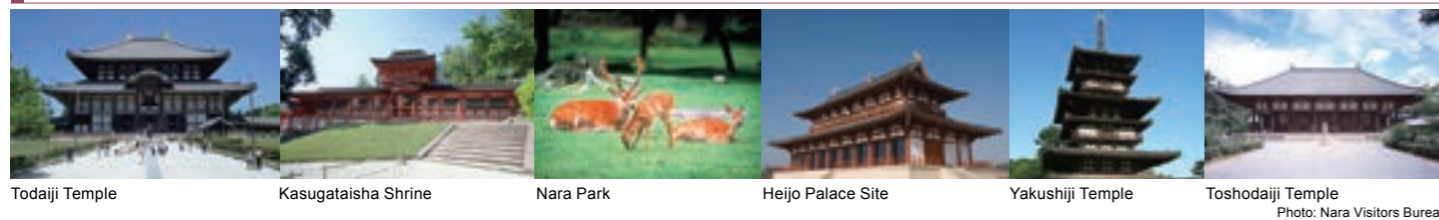

Todaiji Temple Kasugataisha Shrine Nara Park Heijo Palace Site Yakushiji Temple Toshodaiji Temple Photo: Nara Visitors Bureau

**Inquiry**

For Reservations Business hours: 9:00-17:00

**Nara Prefectural Convention Center**  
TEL: +81-742-32-2290 FAX: +81-742-32-2291 E-MAIL: info@nara-cc.jp  
Closed: Mondays (if a public holiday falls on Monday, then the next weekday)  
From January 1 to 4 and December 28 to 31

**MICE Promotion Office, Tourism Bureau of Nara Prefecture**

TEL: +81-742-27-8479 FAX: +81-742-27-1065

More info [www.nara-cc.jp/english](http://www.nara-cc.jp/english)



**NARA Prefecture**

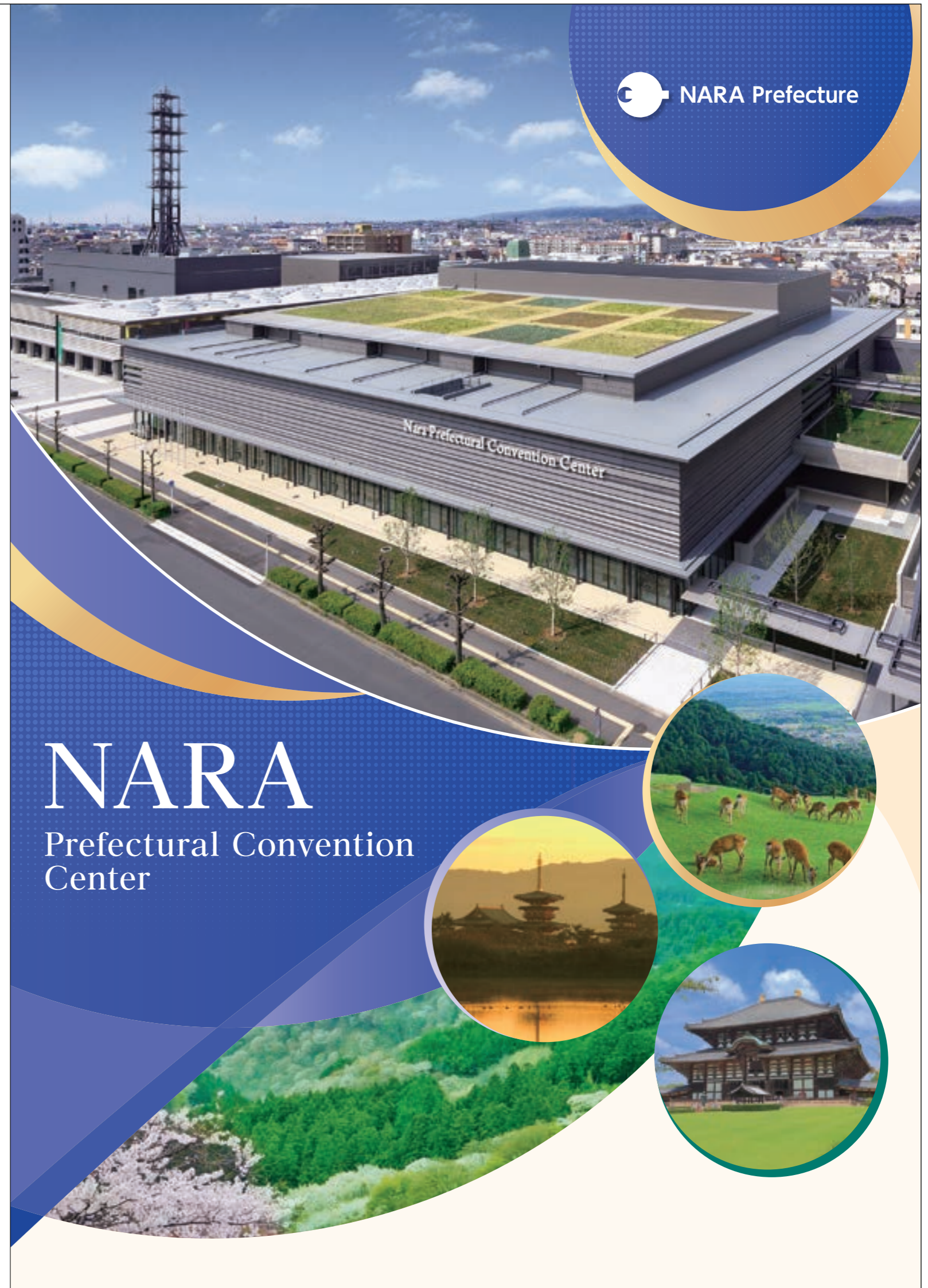

**NARA**  
Prefectural Convention Center



## The place where pleasant landscapes meet functional facilities

Have a memorable event here, where Nara's unique characteristics are integrated into its design and feature.



Tempyo Hall



Bus Terminal



Tempyo Square



JW Marriott Hotel Nara

## Various art pieces made by local artisans

Handcrafted furniture using local wooden materials are placed throughout the complex, adding cultural richness to the place.

## Tourism Promotion Facility

This public facility is built for the purpose of promoting tourism in Nara, offering a variety of locally-produced food and products.

### Shops

- NARA TSUTAYA BOOKS
- Starbucks
- Family Mart Convenience Store
- Nakagawa Masashichi Shoten Shop



NHK New Nara Broadcasting Station

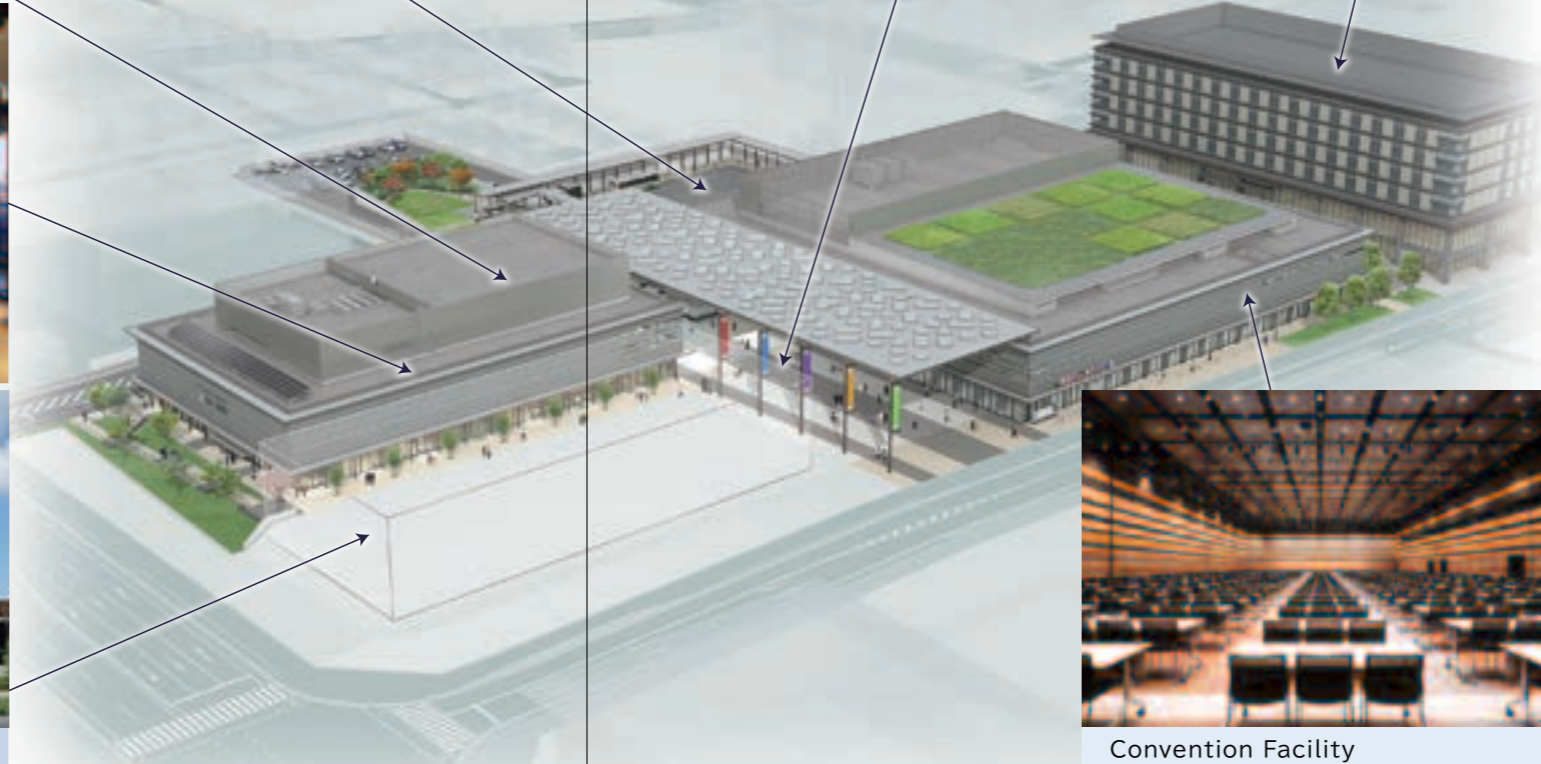

Convention Facility

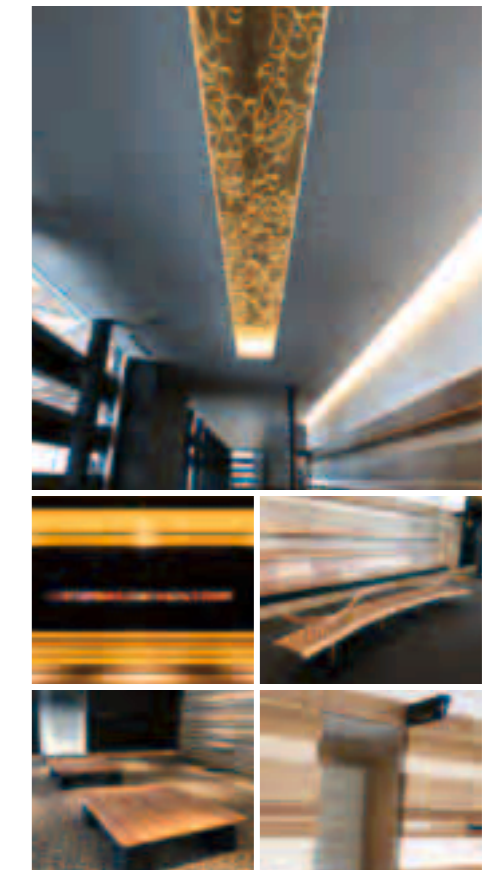

## Overview of Nara Prefectural Convention Center

Classification	Details and usage examples
Location	691-1, 1-chome, Sanjo-oji, Nara city
Number of floors	Underground B2 & B1, First Floor and Second Floor
Convention Facility	1st Floor: Convention Hall, Meeting Rooms 101-108, Waiting Rooms 2nd Floor: Meeting Rooms 201-206, Waiting Rooms (Suitable for international conferences, academic conferences, seminars, exhibitions etc.)
Tempyo Square	Covered Outdoor area (Suitable for Marché, Lunchtime concert etc.)
Tourism Promotion Facility	1st & 2nd Floors: Food & drink and shops (Restaurants, cafés and shops selling local specialties and products etc.)
Tempyo Hall	2nd Floor: <Theater Hall> (Music concerts & performances, movies, exhibition events etc.)
Parking/Bus Terminal	Parking space up to 400 cars (B2, B1 & Ground Floor), Bicycle Parking Bus Terminal (Limousine bus stops and more) and Waiting Rooms etc.

## Floorplan

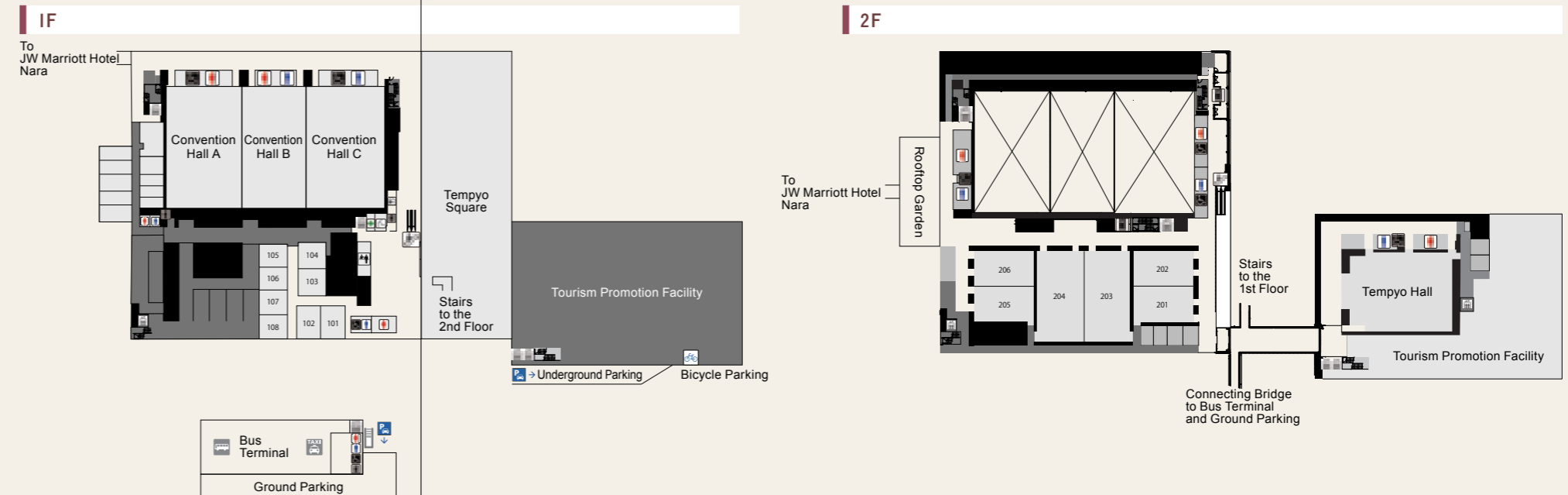

## Convention Hall



Expansive space of 2,100m<sup>2</sup> with a ceiling height of 9.9m  
 Suitable for exhibitions, academic meetings, lectures and parties

- Dividable into three halls with soundproof folding retractable walls
- This flat space can be tailored to a range of events

### Room Rates

(JPY-Tax inclusive)

		Morning (9:00~12:00)	Afternoon (13:00~17:00)	Morning/ Afternoon (9:00~17:00)	Evening (18:00~21:30)	Afternoon/ Evening (13:00~21:30)	All Day (9:00~21:30)
Convention Hall A or C	Weekend/ Holiday	125,100	166,800	291,900	166,800	333,600	417,000
	Weekday	104,250	139,000	243,250	139,000	278,000	347,500
Convention Hall B	Weekend/ Holiday	104,200	139,000	243,200	139,000	278,000	347,400
	Weekday	86,850	115,800	202,650	115,800	231,600	289,500
Convention Hall A · B · C (Combined)	Weekend/ Holiday	354,400	472,600	827,000	472,600	945,200	1,181,400
	Weekday	295,350	393,800	689,150	393,800	787,600	984,500

### Facility Overview

Area	Combined: Approx. 2,100m <sup>2</sup> Divided (into three): [A]: Approx. 730m <sup>2</sup> [B]: Approx. 600m <sup>2</sup> [C]: Approx. 770m <sup>2</sup>
Capacity	Combined: Theater 2,000/ Classroom 1,155/ Banquet 100 round tables (Standing)/ 96 round tables (Seated)  Divided: [A] : Theater 700/ Classroom 360 [B] : Theater 521/ Classroom 300 [C] : Theater 700/ Classroom 360
Ceiling height	9.9m

### Layout plans

#### Theater Style [Combined/Divided]

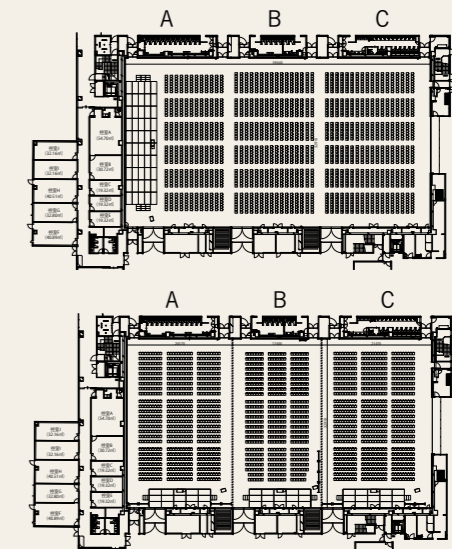

#### Classroom Style [Combined/Divided]

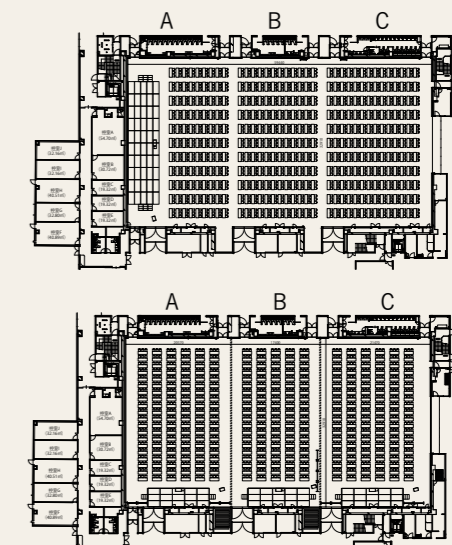

#### Banquet Style [Standing/Seated]

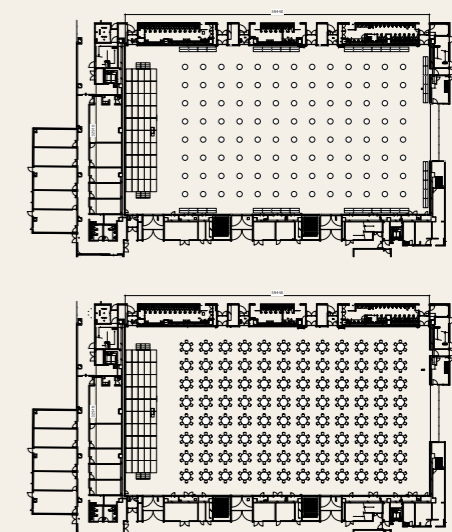

## Meeting Rooms 201~206



High-quality functional meeting rooms that meet diverse needs

- Various sizes of meeting space available from 150m<sup>2</sup> to 300m<sup>2</sup> and 600m<sup>2</sup>
- Ideal for large-scale meetings, committee meetings, seminars and more

### Facility Overview

Meeting Rooms 201/202/205/206	
Area	2 Rooms Combined: Approx. 320m <sup>2</sup> 1 Room: Approx. 160m <sup>2</sup> each
Capacity	2 Rooms Combined: Theater 242/ Classroom 135 1 Room: Theater 150/ Classroom 72
Ceiling height	4.5m

Meeting Rooms 203/204	
Area	2 Rooms Combined: Approx. 630m <sup>2</sup> 1 Room: Approx. 315m <sup>2</sup> each
Capacity	2 Rooms Combined: Theater 528/ Classroom 252 1 Room: Theater 270/ Classroom 156
Ceiling height	4.5m

### Room Rates

		(JPY-Tax inclusive)					
		Morning (9:00~12:00)	Afternoon (13:00~17:00)	Morning/ Afternoon (9:00~17:00)	Evening (18:00~21:30)	Afternoon/ Evening (13:00~21:30)	All Day (9:00~21:30)
Meeting Room 201 or 202	Weekend/ Holiday	29,700	39,600	69,300	39,600	79,200	99,000
	Weekday	24,750	33,000	57,750	33,000	66,000	82,500
Meeting Room 203 or 204	Weekend/ Holiday	59,400	79,200	138,600	79,200	158,400	198,000
	Weekday	49,500	66,000	115,500	66,000	132,000	165,000
Meeting Room 205 or 206	Weekend/ Holiday	29,700	39,600	69,300	39,600	79,200	99,000
	Weekday	24,750	33,000	57,750	33,000	66,000	82,500

### Layout plans

Combined [Theater/ a total of 3 rooms]

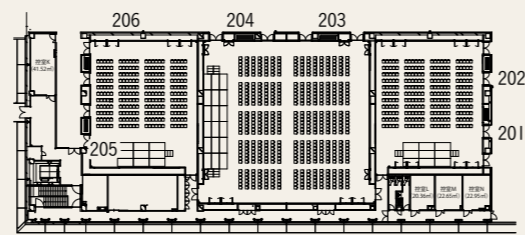

Divided [Theater/ a total of 6 rooms]

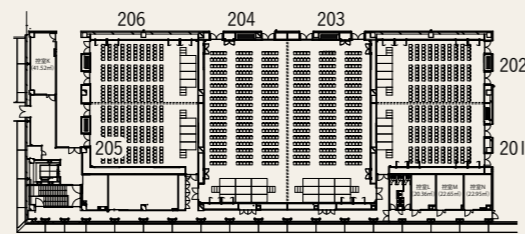

## Meeting Rooms 101~108



Suitable for meetings, seminars and trainings

- Also suitable as waiting rooms for large events

### Facility Overview

Area	2 Rooms Combined: Approx. 100m <sup>2</sup> 1 Room: Approx. 50m <sup>2</sup>
Capacity	2 Rooms Combined: Theater 90 1 Room: Theater 45
Ceiling height	3.0m

### Room Rates

		(JPY-Tax inclusive)					
		Morning (9:00~12:00)	Afternoon (13:00~17:00)	Morning/ Afternoon (9:00~17:00)	Evening (18:00~21:30)	Afternoon/ Evening (13:00~21:30)	All Day (9:00~21:30)
Meeting Room 101-108 each room	Weekend/ Holiday	5,940	7,920	13,860	7,920	15,840	19,800
	Weekday	4,950	6,600	11,550	6,600	13,200	16,500

### Layout plans

Combined [Theater/ a total of 4 rooms]

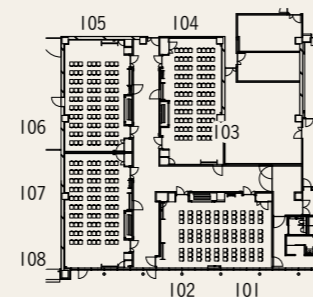

Divided [Theater/ a total of 8 rooms]

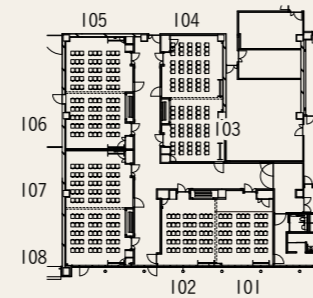

## Tempyo Hall



Approx. 600m<sup>2</sup> Theater Hall / Highly versatile theater space with flexible tiered seats

- Equipped with the latest cinema screen, perfect for film screenings
- Suitable for performances and concerts
- With its automated retractable seats, the hall can be used as a flat space

### Layout plans

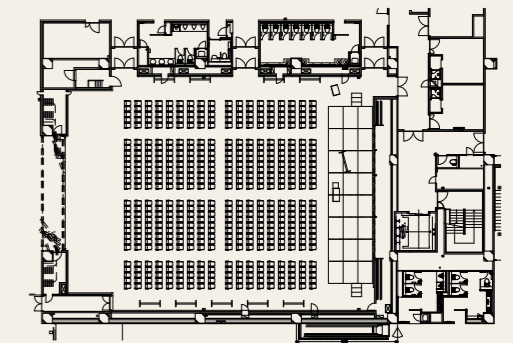

### Facility Overview

Area	Approx. 600m <sup>2</sup>
Capacity	On the flat space: Theater 504 Tiered seating: Theater 476
Ceiling height	8.0m

### Room Rates

		(JPY-Tax inclusive)					
		Morning (9:00~12:00)	Afternoon (13:00~17:00)	Morning/ Afternoon (9:00~17:00)	Evening (18:00~21:30)	Afternoon/ Evening (13:00~21:30)	All Day (9:00~21:30)
Tempyo Hall	Weekend/ Holiday	118,800	158,400	277,200	158,400	316,800	396,000
	Weekday	99,000	132,000	231,000	132,000	264,000	330,000

## Tempyo Square



Spacious covered outdoor space ideal for open-air events

- Square shaped event space of over 1,000m<sup>2</sup>
- The whole area is covered, accommodating all weather conditions
- Ideal for exhibitions, markets and food events

### Facility Overview

Area	Combined: Approx. 1,270m <sup>2</sup> Divided (into four): [A] : Approx. 375m <sup>2</sup> [B] : Approx. 486m <sup>2</sup> [C] : Approx. 265m <sup>2</sup> [D] : Approx. 146m <sup>2</sup>
Ceiling height	13m

### Rental Rates

		(JPY-Tax inclusive)					
		Morning (9:00~12:00)	Afternoon (13:00~17:00)	Morning/ Afternoon (9:00~17:00)	Evening (18:00~21:30)	Afternoon/ Evening (13:00~21:30)	All Day (9:00~21:30)
Tempyo Square (Per 1m <sup>2</sup> )	Weekend/ Holiday	66	66	132	132	198	264
	Weekday	55	55	110	110	165	220

